

ELP9X1CS

Elektronic LED Power Supply
Drive 1...9x1,2W/350mA LED
IP65



I. Technical Data

Allgemein	
Input voltage:	100...240V AC
Input current:	0,25A
Frequency:	50/60Hz
Output current:	DC 350mA constant
Output voltage:	3V...31,5VDC
Load:	1...9 x 1,2W/350mA LED
Power factor:	≥0,45 (@25°C with full load)
Efficiency:	≥70% (@full load)
No-load loss:	≤ 0,5W
Reliability (MTBF):	≥50000 hours (@ 25°C with full load)
Ambient temperature:	-20°C...50°C
Surface temperature:	max. 80°C
Dimmable:	No
Sicherheit und Schutz	
Protection class:	IP65
Isolation class:	Class II, SELV
Over temperature protection:	integrated, automatic resettable after temperature descending
Short circuit protection:	integrated, automatic resettable after temperature descending
Isolation voltage:	4200V AC / 5mA / 1min
Normen und Approval	
Safety Norm:	EN61347-2-13:2006, EN61347-1:2001, EN60598-1:2004+A1:2006
LVD Norm:	Low voltage Directive 2006/95/EC
EMC Norm:	EN55015:2006, EN61547:1995+A1:2000 EN61000-3-2:2006, EN61000-3-3:1995+A1:2001+A2:2005
Approval:	INTERTEK SEMKO
CE Marking	Yes
RoHS compatible:	Yes

II. Construction

Drawing for input

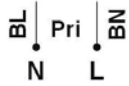

Drawing for output

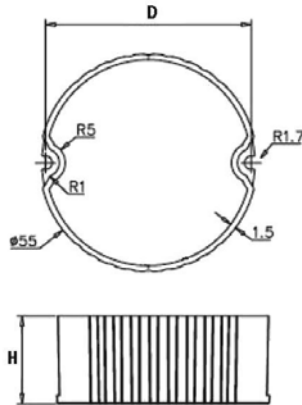
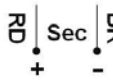

Unit: mm

Dimension	
Diameter:	D=52,1mm
Height:	H=22,1mm
Fixture:	Fixing with 2 x M3 screws
Output drawing	
Input cable:	Blue(BL): Null line (N) Brown(BN): Live line (L) Cable length: 180mm
Output cable:	Red(RD): Positive output (+) Black(BK): Negative output (-) Cable length 130mm (max. 2m)

III. Installation

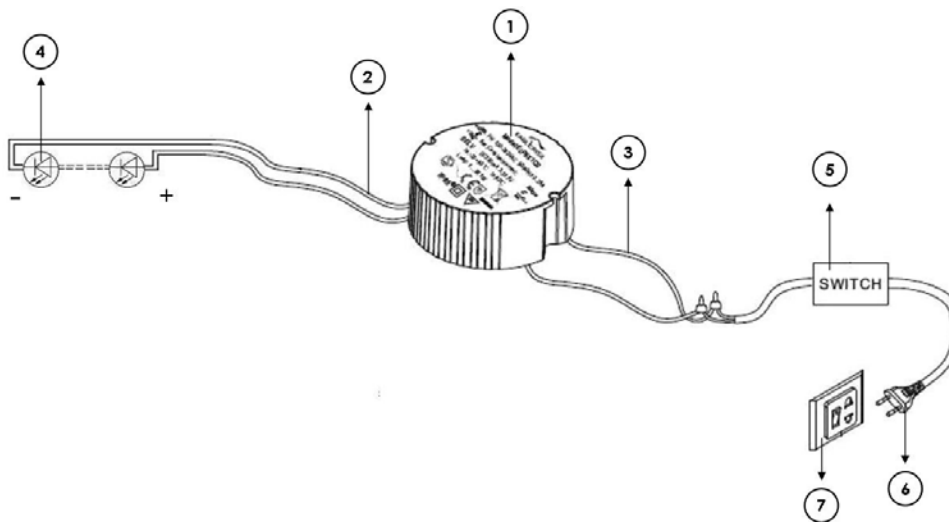

Please refer to the statement for cable colour in the input and output drawing of housing. The output cable can be allowed max. 2,5m to extend.



DANGER! Don't work with connecting electric power! The components in this device may have deadly voltage und high stored energy! All installation works must be performed with specialized personnel!

Components	
1*	LED driver / device body
2	Input cable
3	Output cable (max. 2m)
4*	1...9 x 1,2W/350mA LED
5*	Switch (optional)
6*	Inout plug
7*	Electric power source (220...240V AC)

* not inclusive in the product packing