

4

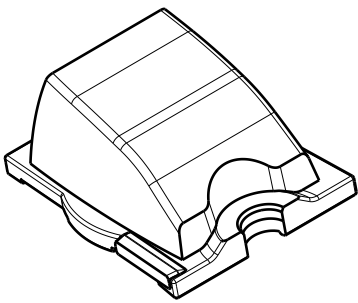

Isometric view

3

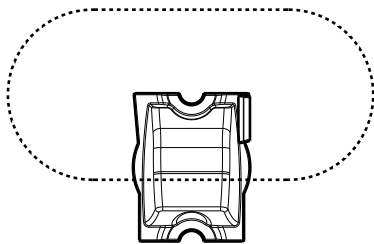

Beam direction

2

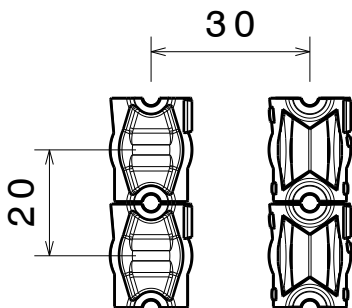

Strada lens arrangement
recomendation

MATERIALS

Lens: PMMA

Tape(optional): PU Foam

Part no. with tape fastening: CA12332_Strada-T-DN

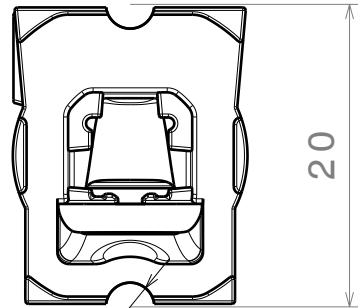

20
fastening

Bottom view

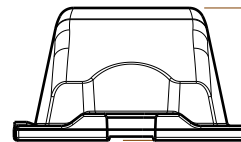
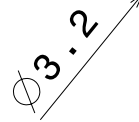

9.2
with tape 9.6

Front view

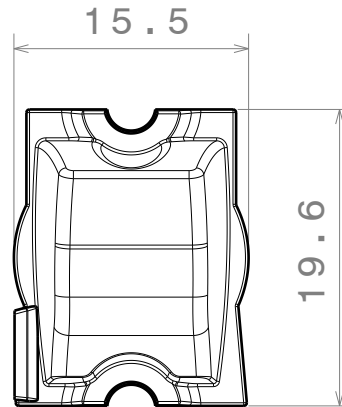

Top view

4

3

2

1

This drawing is our property.
It can't be reproduced
or communicated without
our written agreement.



Ledil Oy
Salorankatu 10
FIN-24100 SALO
Finland

DRAWING TITLE

Datasheet Strada-T-DN Lens

DRAWN BY

ah

DATE

13.12.2011

CHECKED BY

vs

DATE

13.12.2011

DESIGNED BY

hh

DATE

07.09.2011

SIZE

A4

DRAWING NUMBER

C12329

REV

1

SCALE

2:1

WEIGHT (g)

SHEET

1 / 1

D

A