

Isometric view
Scale: 4:1

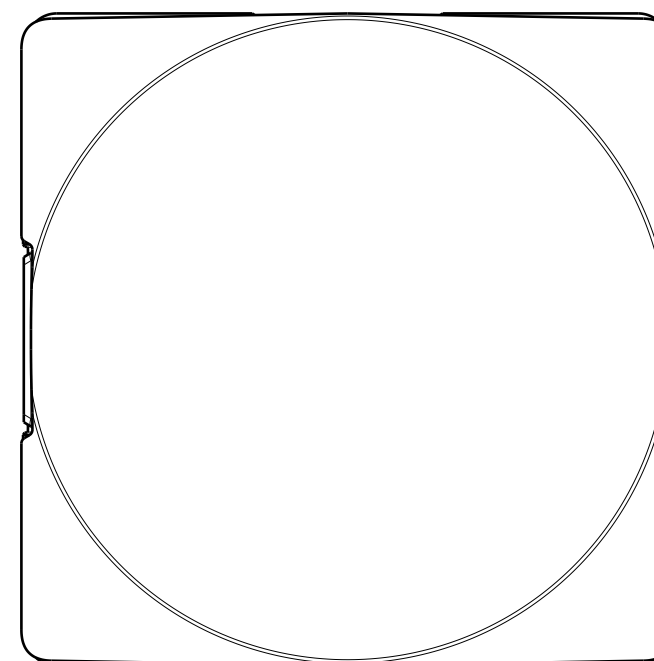

Top view

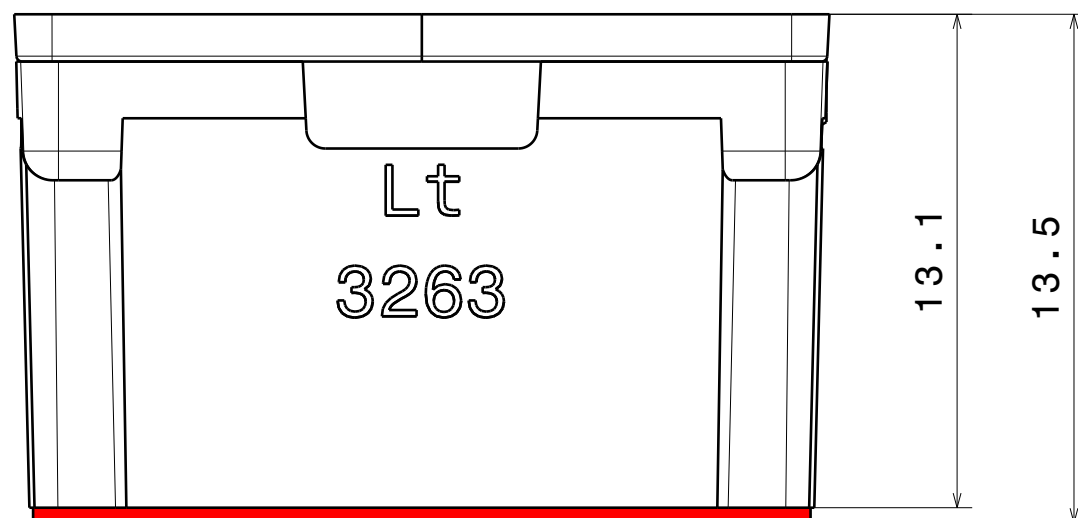

Front view

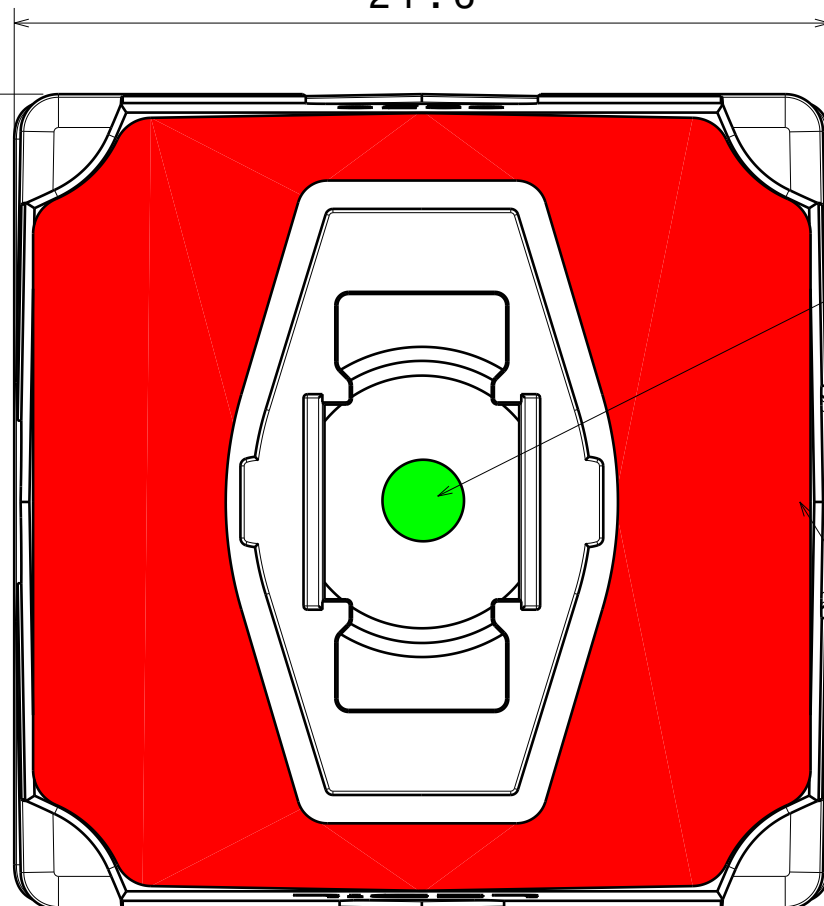

Bottom view

LED position

Tape 0.4mm

material: PMMA
colour: white

MECHANICAL DRAWING

PRODUCT

Rose family datasheet

Plastic moulding general tolerances according to DIN 16901-130 and applies if not otherwise shown in the drawing. Silicone moulding general tolerances according to ISO 3302-1 Class M3 and applies if not otherwise shown in the drawing.

FIRST ANGLE PROJECTION:

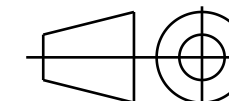

This drawing is the property of LEDiL Oy. It may not be copied or otherwise distributed without prior written permission from LEDiL Oy.

SCALE

1:1

WEIGHT

-

A3

SHEET 1/1

Notes

PCB or heatsink level.

LED location

Ensure LED fitting from a product specific 3D model available from www.ledil.com

For more details about installation please see LEDiL Installation Guide on www.ledil.com

